

**U.S. DEPARTMENT OF HOMELAND SECURITY
FEDERAL EMERGENCY MANAGEMENT AGENCY**

National Flood Insurance Program

ELEVATION CERTIFICATE

IMPORTANT: Follow the instructions on pages 1-9.

OMB No. 1660-0008
Expiration Date: July 31, 2015

FOR INSURANCE COMPANY USE
1404-2483EC

SECTION A - PROPERTY INFORMATION

A1. Building Owner's Name
Tami Renee Newman Isherwood

A2. Building Street Address (including Apt., Unit, Suite, and/or Bldg. No.) or P.O. Route and Box No.
17706 WALL CIRCLE

City
REDINGTON SHORES

State
FLORIDA

A3. Property Description (Lot and Block Numbers, Tax Parcel Number, Legal Description, etc.)
REDINGTON SHORES

A4. Building Use (e.g., Residential, Non-Residential, Addition, Accessory, etc.)**RESIDENTIAL**

A5. Latitude/Longitude: Lat. **N.27.49.49.6** Long. **W.82.49.29.2**

A6. Attach at least 2 photographs of the building if the Certificate is being used to obtain flood insurance.

A7. Building Diagram Number **JA**

A8. For a building with a crawlspace or enclosure(s):
a) Square footage of crawlspace or enclosure(s) **N/A** sq ft
b) Number of permanent flood openings in the crawlspace or enclosure(s) within 1.0 foot above adjacent grade **N/A** sq in
c) Total net area of flood openings in A8.b **N/A** sq in
d) Engineered flood openings? Yes No

A9. For a building with an attached garage:
a) Square footage of attached garage **400** sq ft
b) Number of permanent flood openings in the attached garage within 1.0 foot above adjacent grade **0**
c) Total net area of flood openings in A9.b **0** sq in
d) Engineered flood openings? Yes No

Horizontal Datum: NAD 1927 NAD 1983

Policy Number:
Company NAIC Number:
ZIP Code
33708

LOT 5, BLOCK 3, FOURTH ADDITION TO HARBOR SHORES SUBDIVISION, ACCORDING TO MAP OR PLAT THEREOF AS RECORDED IN PLAT BOOK 31, PAGES 35 AND 36, OF THE PUBLIC RECORDS OF PINELLAS COUNTY, FLORIDA.

SECTION B - FLOOD INSURANCE RATE MAP (FIRM) INFORMATION

B1. NFP Community Name & Community Number
THE TOWN OF REDINGTON SHORES 125141

B2. County Name
PINELLAS

B3. State
FLORIDA

B4. Map/Panel Number **G** B5. Suffix **12103C - 0179** B6. FIRM Index Date **8/18/2009** B7. FIRM Panel Effective/Revised Date **09/03/03** B8. Flood Zone(s) **AE** B9. Base Flood Elevation(s) (Zone AO, use base flood depth) **12**

B10. Indicate the source of the Base Flood Elevation (BFE) data or base flood depth entered in item B9:
 FIS Profile FIRM Community Determined Other/Source:

B11. Indicate elevation datum used for BFE in item B9: NGVD 1929 NAVD 1988 Other/Source:

B12. Is the building located in a Coastal Barrier Resources System (CBRS) area or Otherwise Protected Area (OPA)? Yes No
Designation Date: / / CBRS OPA

SECTION C - BUILDING ELEVATION INFORMATION (SURVEY REQUIRED)

C1. Building elevations are based on:
 Construction Drawings* Building Under Construction* Finished Construction
*A new Elevation Certificate will be required when construction of the building is complete.

C2. Elevations - Zones A1-A30, AE, AH, A (with BFE), VE, V1-V30, V (with BFE), AR, AR/A, AR/AE, AR/A1-A30, AR/AH, AR/AO. Complete items C2.a-h below according to the building diagram specified in item A7. In Puerto Rico only, enter meters.

Benchmark Utilized: **REAL_TIME_NETWORK_L-NET (GPS); IBM-.534** Vertical Datum: **NAVD:1988**

Indicate elevation datum used for the elevations in items a) through h) below. NGVD 1929 NAVD 1988 Other/Source:
Datum used for building elevations must be the same as that used for the BFE.

- Check the measurement used.
- a) Top of bottom floor (including basement, crawlspace, or enclosure floor) **6 . 12** feet meters
 - b) Top of the next higher floor **15 . 88** feet meters
 - c) Bottom of the lowest horizontal structural member (V Zones only) **N/A** feet meters
 - d) Attached garage (top of slab) **6 . 01** feet meters
 - e) Lowest elevation of machinery or equipment servicing the building (Describe type of equipment and location in Comments) **6 . 28** feet meters
 - f) Lowest adjacent (finished) grade next to building (LAG) **5 . 70** feet meters
 - g) Highest adjacent (finished) grade next to building (HAG) **6 . 00** feet meters
 - h) Lowest adjacent grade at lowest elevation of deck or stairs, including structural support **6 . 00** feet meters

SECTION D - SURVEYOR, ENGINEER, OR ARCHITECT CERTIFICATION

This certification is to be signed and sealed by a land surveyor, engineer, or architect authorized by law to certify elevation information. I certify that the information on this Certificate represents my best efforts to interpret the data available. I understand that any false statement may be punishable by fine or imprisonment under 18 U.S. Code, Section 1001.

Check here if comments are provided on back of form. Were latitude and longitude in Section A provided by a licensed land surveyor? Yes No

Certifier's Name PAUL VALENTINE	License Number 4512
Title PROFESSIONAL SURVEYOR AND MAPPER	Company Name EXACTA LAND SURVEYORS, INC.
Address 11940 FAIRWAY LAKES DRIVE SUITE 1	City FT. MYERS
State FL	State FL
ZIP Code 33913	ZIP Code 33913
Signature <i>Paul Valentine</i>	Date 4/23/2014
	Telephone P: (813)549-4947

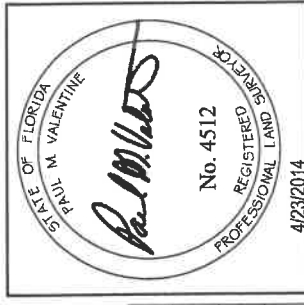

IMPORTANT: In these spaces, copy the corresponding information from Section A.	
Building Street Address (including Apt., Unit, Suite, and/or Bldg. No.) or P.O. Route and Box No.	FOR INSURANCE COMPANY USE Policy Number:
City	Company NAIC Number:
State	ZIP Code

If submitting more photographs than will fit on the preceding page, affix the additional photographs below. Identify all photographs with: date taken; "Front View" and "Rear View"; and, if required, "Right Side View" and "Left Side View." When applicable, photographs must show the foundation with representative examples of the flood openings or vents, as indicated in Section A8.